

# DILATOFLEX®

## DILATOFLEX® KT

### INTEGRATED TIE RODS - ELONGATION LIMITERS

- Allow small lateral movement
- Fitted with rubber bushings for vibration absorption

| Nominal Diameter | Longueur nominale | Drilling Standards (1)<br>NF EN 1092-1 | ASME B16.5 | Max. W.P. (**) (3) (3) | Steel Ring Required for Vacuum Greater than ...% | Max. Permissible Movements<br>(maximum values do not apply simultaneously) |            |         |         | Equilibrium Length at 10 bar<br>AUTOSTABLE:<br>Reaction Force=0 daN | Approximate Weight<br>(steel flanges PN 10/PN 16) |      |
|------------------|-------------------|--|------------|------------------------|--|--|------------|---------|---------|---|---|------|
|                  |                   |  |            |                        |  | Compression  | Elongation | Lateral | Angular |   |   |      |
| DN               | Ln (mm)           | PN 10                                  | PN 16      | CL150                  | PS (bar)   | 100%   | 30%        | 10%     | 5%      | 0   | 130   | (kg) |
| 32               | 1 1/4             | X                                      | -          | 16                     | 100%   | 10   | 10         | 5       | 0       | 130   | 5.7   |      |
| 40               | 1 1/2             | X                                      | X          | 16                     | 100%   | 10   | 10         | 5       | 0       | 130   | 5.7   |      |
| 50               | 2                 | X                                      | X          | 16                     | 30%  | 10   | 10         | 5       | 0       | 130   | 6.3   |      |
| 65               | 2 1/2             | X                                      | X          | 16                     | 30%  | 10   | 10         | 5       | 0       | 130   | 7.3   |      |
| 80               | 3                 | X                                      | X          | 16                     | 30%  | 10   | 10         | 5       | 0       | 130   | 8.0   |      |
| 100              | 4                 | X                                      | X          | 16                     | 30%  | 10   | 10         | 5       | 0       | 135   | 9.5   |      |
| 125              | 5                 | X                                      | X          | 16                     | 30%  | 10   | 10         | 5       | 0       | 140   | 14.7  |      |
| 150              | 6                 | X                                      | X          | 16                     | 30%  | 10   | 10         | 5       | 0       | 140   | 17.1  |      |
| 200              | 8                 | X                                      | X          | 16                     | 30%  | 5  | 10         | 5       | 0       | 145   | 27  |      |

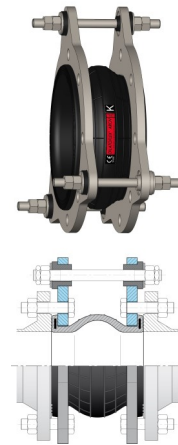

(1) Other drillings available (e.g. PN 6, PN 25, BS 10D-E...).

Floating flanges in zinc-chromated, hot-dip galvanized or stainless (304L or 316L) steel.

(2) Limited to the nominal pressure of the used drilling standard.

(3) Particular cases:

CC grade: W.P. 10 bar at +110 °C max. and W.P. 16 bar at +90 °C max.

DW grade: W.P. 12 bar at +105 °C max. and W.P. 16 bar at +90 °C max.

DW inner lining is certified ACS (Attestation de Conformité Sanitaire), WRAS and UBA

### OTHER TIE RODS SYSTEMS

#### HINGED TIE RODS

For angular movement

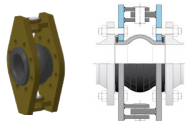

#### LATERAL TIE RODS

For lateral movement

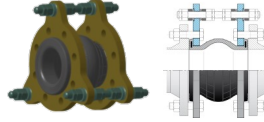

### Inner lining grade and working temperature

**CC** -35 °C  
+90 °C/110 °C

**DW** -25 °C  
+90 °C/105 °C

**EPC** -25 °C  
+95 °C

**AR/CN** -35 °C  
+90 °C

**GZ** -20 °C  
+90 °C

**YP** -25 °C  
+100 °C

**AB** -35 °C  
+100 °C

**TE** -25 °C  
+100 °C

anvis Decize S.A.S.

Usine des Caillots—BP101—F-58302 DECIZE CEDEX

dilatoflex@anvisgroup.com — www.dilatoflex.com

anvis